

# Plat of Survey

of  
**Tax Parcel XCDB3 00002,**  
being Block B of Delavan Business Park No. 3, located in the Northwest 1/4 of the Northwest 1/4 of Section 16, Town 2 North, Range 16 East, City of Delavan, Walworth County, Wisconsin, EXCEPTING THEREFROM lands conveyed by Documents numbered 244471, 311500, 327972, 337875 & 360460.

**More particularly described as:**  
Part of Block B of Delavan Business Park No. 3, located in the Northwest 1/4 of the Northwest 1/4 of Section 16, Town 2 North, Range 16 East, City of Delavan, Walworth County, Wisconsin, described as follows: Begin at the Northeast corner of said Block B; thence South 1°11'43" East 225.00 feet; thence South 88°48'50" West 276.40 feet; thence North 20°34'59" West 220.49 feet to the South line of Woolsey Street; thence Northeastly along said South line and the arc of a curve to the right (Radius=268.75, Chord= North 78°14'48" East 102.17 feet) 102.80 feet; thence North 89°12'15" East 249.15 feet to the Point of Beginning.

Surveyed for: **Thorpe & Christian, S.C.**  
1624 Hobbs Drive, Suite 1  
Delavan, Wisconsin. 53115

**Legal Description of Proposed Easement**  
Part of Block B of Delavan Business Park No. 3, located in the Northwest 1/4 of the Northwest 1/4 of Section 16, Town 2 North, Range 16 East, City of Delavan, Walworth County, Wisconsin, described as follows: Commencing at the Northeast corner of said Block B; thence South 89°12'15" West, along the South line of Woolsey Street, 35.00 feet to the Point of Beginning; thence South 1°12'00" East 20.00 feet; thence North 88°48'00" East 35.00 feet to the East line of said Block B; thence South 1°12'00" East, along the East line of Block B, 205.29 feet; thence South 88°49'06" West 142.17 feet; thence North 1°12'00" East 45.70 feet; thence South 88°48'00" West 150.00 feet; thence North 20°34'36" West 172.12 feet to the South line of Woolsey Street; thence Northeastly along said South line and the arc of a curve to the right (Radius=268.75, Chord= North 70°43'01" East 31.98 feet) 32.00 feet; thence South 16°00'00" East 24.73 feet; thence South 20°34'36" East 110.00 feet; thence South 56°26'12" East 25.64 feet; thence North 88°48'00" East 155.00 feet; thence North 1°12'00" West 150.00 feet thence North 89°12'15" East 65.00 feet to the Point of Beginning.

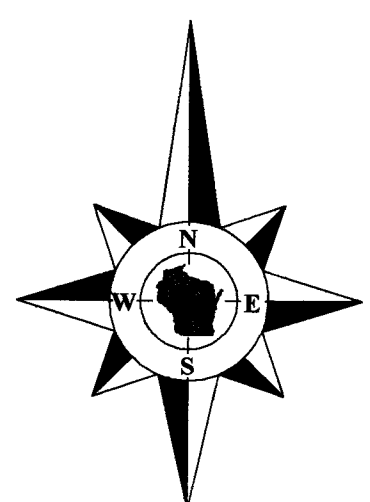

DEC 14 2017  
SMF

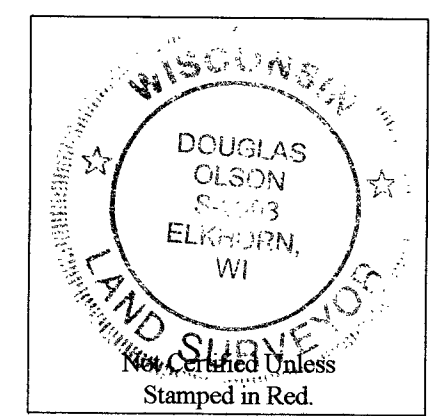

Bearings referenced to the North line of the Northwest 1/4 Section 16-2-16, recorded as N88°29'38"E in the Wisconsin State Plane Coordinate System, South Zone, (NAD-27).

- Notes:**
- 1) This Plat of Survey is not certified unless signed and sealed in red ink.
  - 2) This survey is subject to Wisconsin lien laws. This Plat of Survey is the notice of intent to file lien. Lien waiver required.
  - 3) The Survey Date shown on this Plat of Survey is the completion date of the field work.

Copyright ©2017 by Olson Land Surveying, LLC.

All rights reserved. No part of this survey plat may be reproduced or transmitted in any form by any means - graphic, electronic, or mechanical, including photocopying, tracing, or information storage and retrieval systems - without permission in writing from Douglas G. Olson, Olson Land Surveying, LLC.

I hereby certify that I have surveyed the above described property in compliance with Chapter A-E 7 of the Wisconsin Administrative Code and that the map hereon is correct to the best of my knowledge and belief.

Douglas G. Olson  
Wisconsin Professional Land Surveyor - 2093

Survey Date: August 19, 2017.  
Revisions: No. 1 - Proposed Easement

Scale in Feet  
1" = 30'  
0' 15' 30' 60' 90'

45 South Wisconsin Street | P.O. Box 322  
Elkhorn, Wisconsin. 53121  
Telephone: (262) 723-3434  
Facsimile: (262) 723-8044  
Email: doug@olsonsurveying.com  
Website: www.olsonsurveying.com

**OLSON**  
LAND SURVEYING, LLC  
Rural | Residential | Commercial

North	North Arrow
South	South Arrow
East	East Arrow
West	West Arrow
Found County Section Corner	Found County Section Corner
Found Iron Pipe	Found Iron Pipe
Found Iron Rod	Found Iron Rod
Set Iron Pipe, 1" dia.	Set Iron Pipe, 1" dia.
Set Iron Rod, 1" dia.	Set Iron Rod, 1" dia.
Set Iron Pipe, 1/2" dia.	Set Iron Pipe, 1/2" dia.
Set Iron Rod, 1/2" dia.	Set Iron Rod, 1/2" dia.
Utility Box Pedestal	Utility Box Pedestal
Utility Box	Utility Box
Fire Hydrant	Fire Hydrant
Asphalt Surface	Asphalt Surface
Concrete Surface	Concrete Surface

Sheet 1 of 1 Sheets

Job Reference Number  
2017095

2017.095